

STIHL TS 800 - Demolition saw 400mm - diamond (petrol)

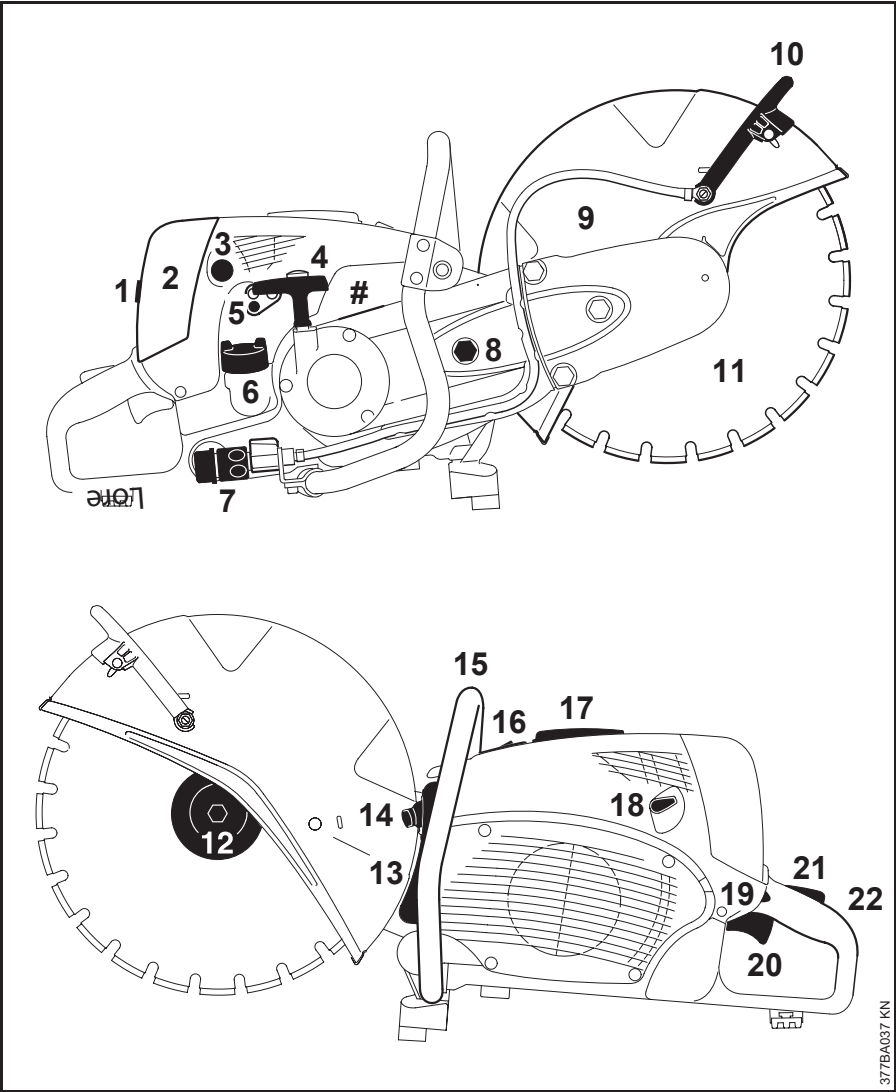

1	Screw plug
2	Filter cover
3	Manual fuel pump
4	Starter grip
5	Carburetor adjusting screws
6	Filler cap
7	Water attachment
8	Tensioning nut
9	Guard
10	Adjusting lever
11	Abrasive wheel
12	Front thrust washer
13	Muffler
14	Spark arresting screen
15	Handlebar
16	Decompression valve
17	Cap for spark plug boot
18	Choke lever
19	Master control lever
20	Throttle trigger
21	Throttle lever lock
22	Rear handle
#	Machine number

GENERAL SPECIFICATIONS	
Fuel tank capacity	1200cm ³
Weight	16kg
Blade	400mm diamond
Max cutting depth	150mm
Power	2 stroke petrol
Water supply	Mains water required on site

ENGINE	
Model	STIHL single cylinder two-stroke engine
Displacement	98.5cm ³
Cylinder bore	56mm
Piston stroke	40mm
Engine power according to ISO 7293	5.0 kW (6.8 HP) at 9300 rpm
Idling speed	2200 rpm
Max. spindle speed to ISO 19432	4290 rpm

ALSO REFER TO: HAZARD ASSESSMENT SHEET | OPERATING PROCEDURE